

FL625 NTN Deep Groove Ball Bearings

Bearing No. FL625

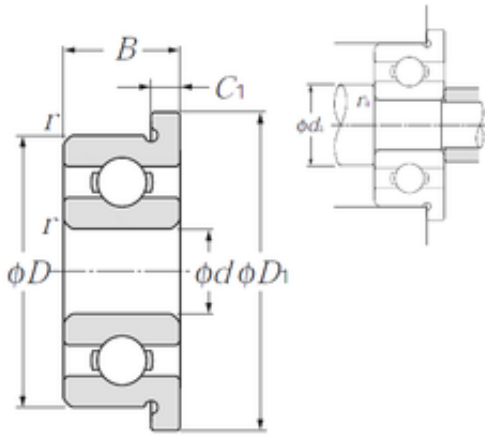

FL625 Bearing 2D drawings and 3D CAD models

| | |
|-------------------------------|--------------|
| Size | 5x18x5 mm |
| Bore Diameter | 5 mm |
| Outer Diameter | 18 mm |
| Width | 5 mm |
| d | 5 mm |
| D | 16 mm |
| D1 | 18 mm |
| B | 5 mm |
| r min. | 0,3 mm |
| C1 | 1 mm |
| da min. | 7 mm |
| da max | 7,6 mm |
| Da max. | 14 mm |
| ra max. | 0,3 mm |
| Weight | 5,2 Kg |
| Basic dynamic load rating (C) | 1,76 kN |
| Basic static load rating (C0) | 0,68 kN |
| (Grease) Lubrication Speed | 37 000 r/min |
| (Oil) Lubrication Speed | 44 000 r/min |